

1 2 3 4 5 6 7 8 9 10 11 12 13 14 15 16

A B C D E F G H J K L M

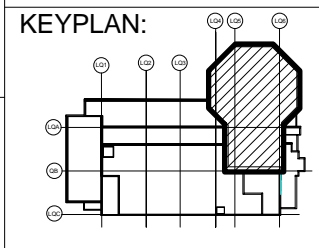

Section A-A

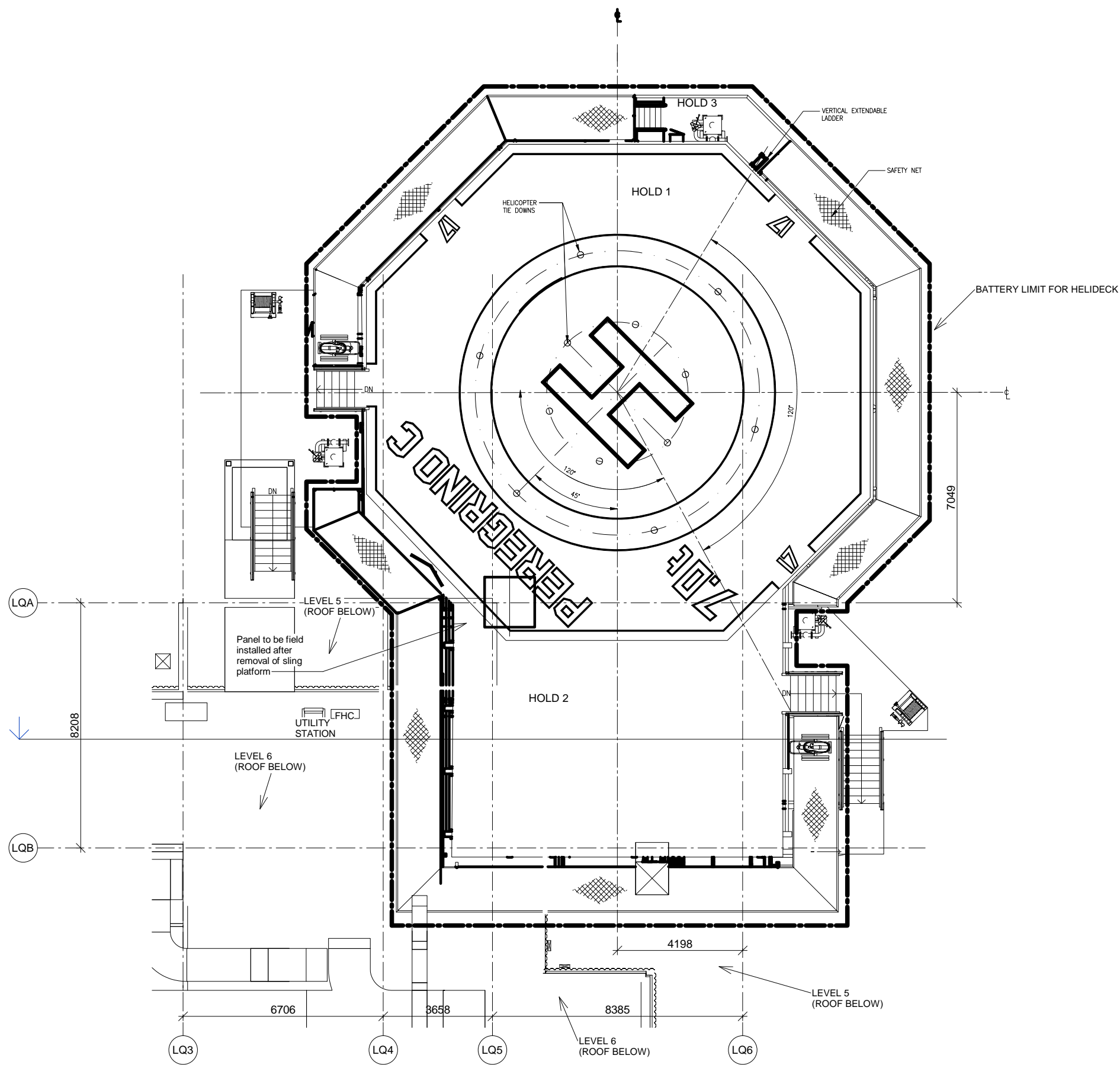

NOTES:

HOLD

1. Hold for Helideck location in east west direction.
2. Hold for LOS sector and Drop sector.
3. Hold for Platform arrangement.

REF	DRW.NO.	REF.DRW.TITLE
1	C140-AL-C-XX-0003-01	Exterior Elevation North
2	C140-AL-C-XX-0004-01	Exterior Elevation East
3	C140-AL-C-XX-0005-01	Exterior Elevation West
4	C140-AL-C-XX-0006-01	Exterior Elevation South
5	C140-AL-C-LF-0001-01	Architectural Symbol & Legend List
6	C140-AL-C-XS-0001-01	Interior Building Section East - West A-A
7	C140-AL-C-XS-0002-01	Interior Building Section North - South B-B



REV.	DATE	REASON FOR ISSUE	MADE BY	CHECK'D BY	DISC.APPR.	PROJ.APPR.
03	19.01.18	Issued for Detail Design	MTOd	ØHE	IHB	
02	16.11.17	Issued for Review	MTOd	ØHE	IHB	
01	25.10.17	Issued for IDC	MTOd	ØHE	IHB	



CONT.NO 4600025422
1:150 AT A3 H700 93

Peregrino II- WHP C Living Quarter EPC	
DRAWING TITLE Architectural GA Deck Layout Helideck	
C140-AL-C-XD-0701-01	03
DRAWING NUMBER	REV.

1 2 3 4 5 6 7 8 9 10 11 12 13 14 15 16