

HELIDECK TOP VIEW
SCALE 1:100

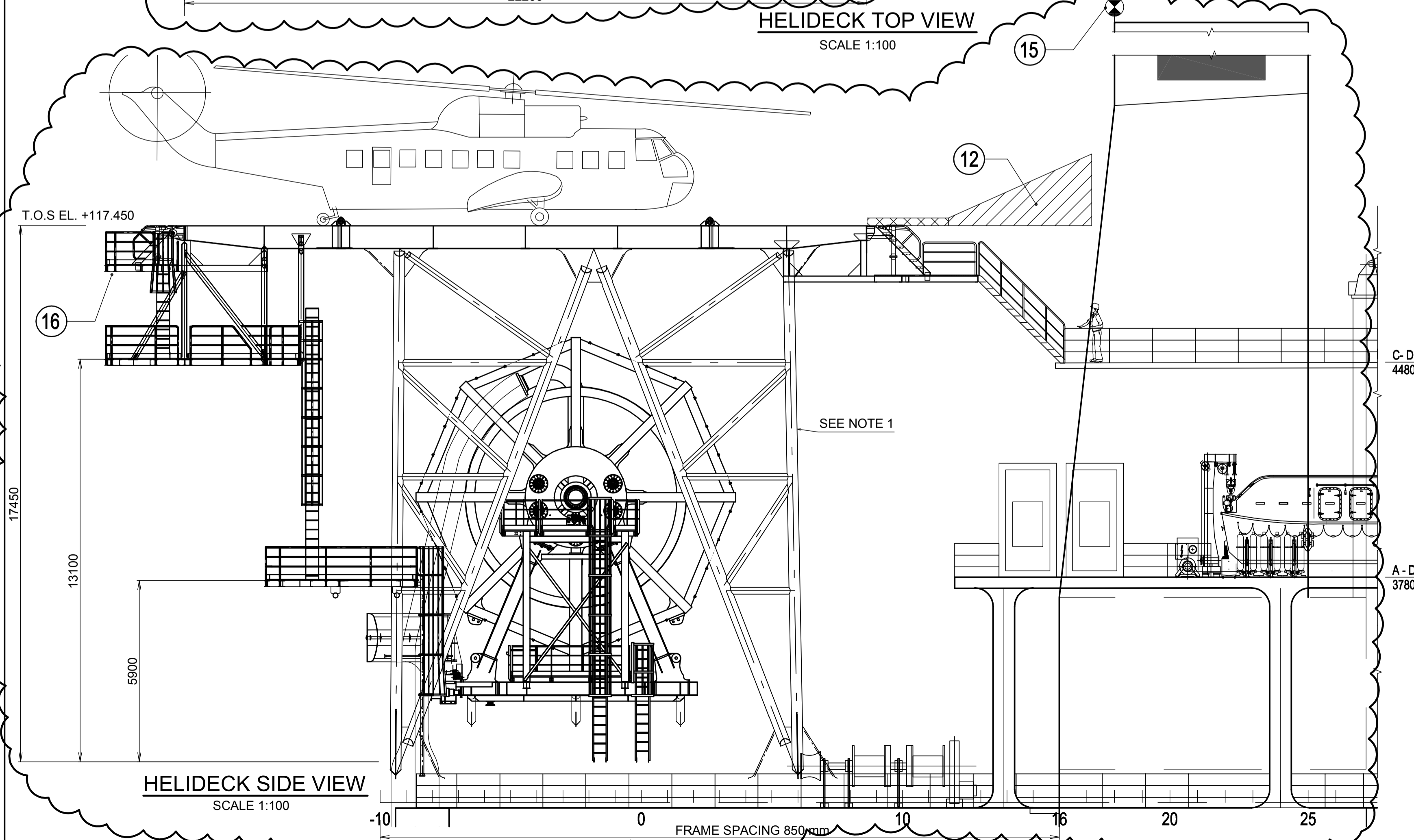

HELIDECK SIDE VIEW
SCALE 1:100

ID	DESCRIPTION
1	WHEELED DRY POWDER EXTINGUISHER TYP. (MIN. 50 kg)
2	FOAM MONITOR MONITOR DE ESPUMA
3	ACCESS TO HELIDECK SEE NOTE 5 ACESSO AO HELIPORTO VER NOTA 5
4	REFUELING STATION
5	WHEELED CO2 EXTINGUISHER TYP. (MIN. 3x22.5 kg)
6	ANTISKID LANDING NET 15mx15m REDE DE PROTECÇÃO 15mx15m
7	EMERGENCY EXIT SAIDA DE EMERGENCIA
8	APPROACH DEPARTURE SECTOR SECTOR DE APROXIMACAS PARA PARTIDA
9	GUTTER DRAIN PONTOS DE DRENAGEM
10	TIE DIE POINT TYP. 22mm MAX. SWL 5T. PONTO DE INTERCEPÇÃO INFERIOR, TÍPICO
11	SAFETY NET REDE DE SEGURANCA
12	LIMITED OBSTRUCTION AREA ZONA DE OBSTRUÇÃO LIMITADA
13	LIFE JACKET STORE BOX TYPICAL ARMAZEM DE COLETE SALVA-VIDAS TÍPICO
14	TOOLS STORE BOX TYPICAL ARMAZEM DE FERRAMENTAS TÍPICO
15	RED OBSTACLE LIGHT LUZ VERMELHA DE OBSTÁCULO
16	QRH-LIGHTS SHUTTLE TANKER (SEE NOTE 3) QRH-LUZES PETROLEIRO (VER REF.3)

- GENERAL NOTES**
- THE HELIDECK SUITABLE FOR SIKORSKY HELICOPTERS S-61N (WEIGHT 9,3 TONS AND OVERALL LENGTH 22300 mm) AND S-92A (WEIGHT 12,9 TONS AND OVERALL LENGTH 21300 mm) IN ACCORDANCE WITH NORMAM-01/DPC/2005 BY DPC (NAVY PORTS AND SHORES DIRECTORATE) HELIPORTO APROPRIADO PARA OS HELICÓPTEROS SIKORSKY S-61N (PESO DE 9,3 TONELADAS E COMPRIMENTO TOTAL 22300 mm) E S-92 A (PESO DE 12,9 TONELADAS E COMPRIMENTO TOTAL 21300 mm) DE ACORDO COM A NORMAM-01/DPC/2005 BY DPC (DIRETORIA DE PORTOS E COSTAS)
 - T.O.S. = TOP OF STEEL, T.O.G. = TOP OF GRATING, B.O.S. = BOTTOM OF STEEL. T.O.S. = TOPO DE AÇO, T.O.G. = TOPO DA GRADE, B.O.S. = FUNDO DE AÇO.
 - THE WARNING-LIGHTS FOR SHUTTLE TANKER SHOULD BE POSITIONED AT THE MOST AFT ESCAPE (EMERGENCY) EXIT. AS LUZES DE AVISO RELATIVAS AOS PETROLEIRO DEVEM SER POSICIONADAS NO LOCAL MAIS ATRÁS DO NAVIO PERTO DA SAIDA ESCAPATÓRIA (DE EMERGENCIA).
 - WINDSOCK TO BE PROVIDED IN UNOBSTRUCTED AREA AND READILY VISIBLE DAY & NIGHT. INDICADORES DE DIREÇÃO DE VENTO PARA SEREM POSICIONADOS EM ZONAS NÃO OBSTRUÍDAS E FACILMENTE VISÍVEIS DURANTE O DIA E NOITE.
 - HELIDECK ACCESS STRUCTURAL DETAIL TO BE DETERMINED BY THE YARD. HELIPORTO DETALHE ESTRUTURAL A SER DETERMINADO PELO ESTALEIRO.
 - WINDSOCK LOCATION SEE REF. 1.

- NOTES**
- | ID | DESCRIPTION |
|----|---|
| 1 | HELIDECK STRUCTURE AND PIPING SHOWN ARE ON HOLD |
| 2 | PRIMARY ACCESS TO THE HELIDECK ON HOLD |
| 3 | |

REFERENCE DOCUMENTS

ID	SBM DOC. NUMBER	DESCRIPTION
1	PEDWNAPG003040	FPSO-ACCOMMODATION - VIEWS AND SECTIONS-ARRANGEMENT PLAN
2	PEDWNAPG004002	FPSO-HELIDECK MARKING-PLAN
3	PEDWNAPG004003	FPSO-HELIDECK SAFETY NETS & MARKINGS-ARRANGEMENT
4	PEDWSTTS004600	TOPSIDES-VE204 HELIDECK-ARRANGEMENT
5	PEDWNAPG002001	FPSO-GENERAL-ARRANGEMENT PLAN
6	PEDWSTTS004601	TOPSIDES-VE204 HELIDECK-CONSTRUCTION DRAWING 1
7	PEDWSTTS004602	TOPSIDES-VE204 HELIDECK-CONSTRUCTION DRAWING 2
8	PEDWSTTS004603	TOPSIDES-VE204 HELIDECK-CONSTRUCTION DRAWING 3
9	PEDWSTTS004604	TOPSIDES-VE204 HELIDECK-CONSTRUCTION DRAWING 4
10	PEDWSTTS004605	TOPSIDES-VE204 HELIDECK-CONSTRUCTION DRAWING 5
11	PEDWSTTS004606	TOPSIDES-VE204 HELIDECK-CONSTRUCTION DRAWING 6
12	PEDWSTTS004607	TOPSIDES-VE204 HELIDECK-CONSTRUCTION DRAWING 7
13	PEDWSTTS004608	TOPSIDES-VE204 HELIDECK-CONSTRUCTION DRAWING 8
14	PEDWSTTS004609	TOPSIDES-VE204 HELIDECK-CONSTRUCTION DRAWING 9
15	PEDWSTTS004610	TOPSIDES-VE204 HELIDECK-CONSTRUCTION DRAWING 10
16	PEDWSTTS004611	TOPSIDES-VE204 HELIDECK DRAINS & TIE-DOWN-CONSTRUCTION DRAWING
17	PEDWSTTS004612	TOPSIDES-VE204 HELIDECK EMERGENCY EXITS-CONSTRUCTION DRAWING 1
18	PEDWSTTS004613	TOPSIDES-VE204 HELIDECK EMERGENCY EXITS-CONSTRUCTION DRAWING 1
19	PEDWSTTS004614	TOPSIDES-VE204 HELIDECK EMERGENCY EXITS-CONSTRUCTION DRAWING 2

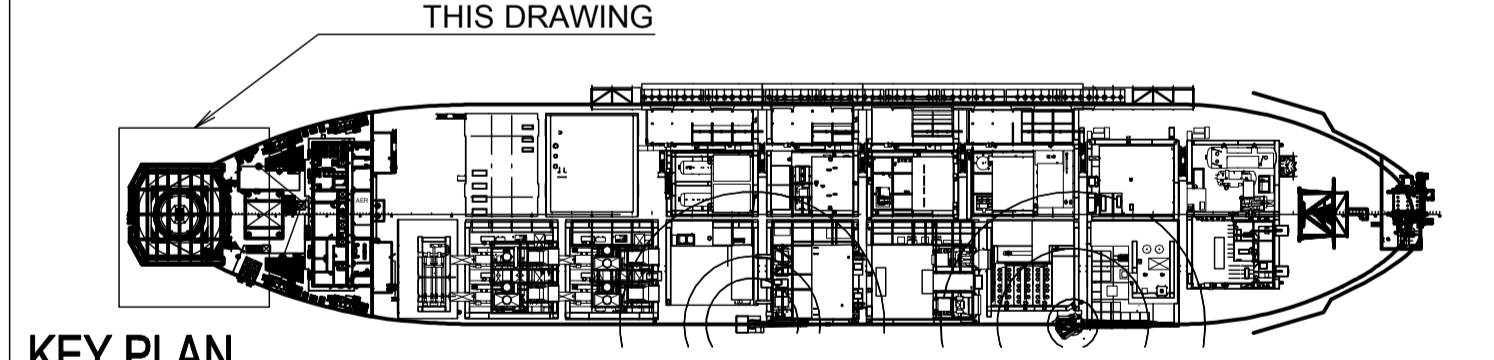

KEY PLAN

Revision	Date (dd-MMM-yy)	Description of revision	Prepared by	Engineering checked by	Approved by	Approved by EPM
C2	20-APR-12	ISSUE FOR COMMENT AND/OR APPROVAL	Gou	Dua	Vdv	Boo
C1	05-APR-12	PRELIMINARY ISSUE FOR INFORMATION	LGB	Ses	Vdv	Boo

Client: **PETROBRAS NETHERLANDS BV**

Project: **FPSO CIDADE DE ILHABELA**

Title: **FPSO HELIDECK ARRANGEMENT PLAN**

Format: A1 | Projection Method: [Symbol] | Scale: 1:100 | Project Number: HI 39520 | Document Number: PEDWNAPG004001 | Sheet No./Sheets/Revision: 1 / 1 / C2

Engineering Subcontractor: SBM OFFSHORE INC. | © Copyright SBM Offshore N.V. 2012