

LEGENDA

EXISTENTE	PROJETO

CADASTRO	
D	= DIAMETRO
L	= COMPRIMENTO
E	= ESCONDSIDADE
I	= DECLIVIDADE
BSTC	BUEIRO SIMPLES TUBULAR DE CONCRETO
BBTC	BUEIRO DUPLO TUBULAR DE CONCRETO
BTTC	BUEIRO TRIPLO TUBULAR DE CONCRETO
BSCC	BUEIRO SIMPLES CELULAR DE CONCRETO
BDCC	BUEIRO DUPLO CELULAR DE CONCRETO
BTCC	BUEIRO TRIPLO CELULAR DE CONCRETO

PROJETADO	
D	= DIAMETRO
L	= COMPRIMENTO
E	= ESCONDSIDADE
I	= DECLIVIDADE
BSTC	BUEIRO SIMPLES TUBULAR DE CONCRETO
BBTC	BUEIRO DUPLO TUBULAR DE CONCRETO
BTTC	BUEIRO TRIPLO TUBULAR DE CONCRETO
BSCC	BUEIRO SIMPLES CELULAR DE CONCRETO
BDCC	BUEIRO DUPLO CELULAR DE CONCRETO
BTCC	BUEIRO TRIPLO CELULAR DE CONCRETO

SP-N'	SONDAGEM A PERCUSSAO
ST-N'	SONDAGEM A TRADO
SPP-N'	SONDAGEM A PA E PICARETA
	AREA DE SUPRESSAO VEGETAL - ASV
	AREA DE DEPOSITO DE MATERIAL PROVISORIA - ADMP
	INDICACAO DE NORTE
	INDICACAO DE COORDENADAS - MARCOS

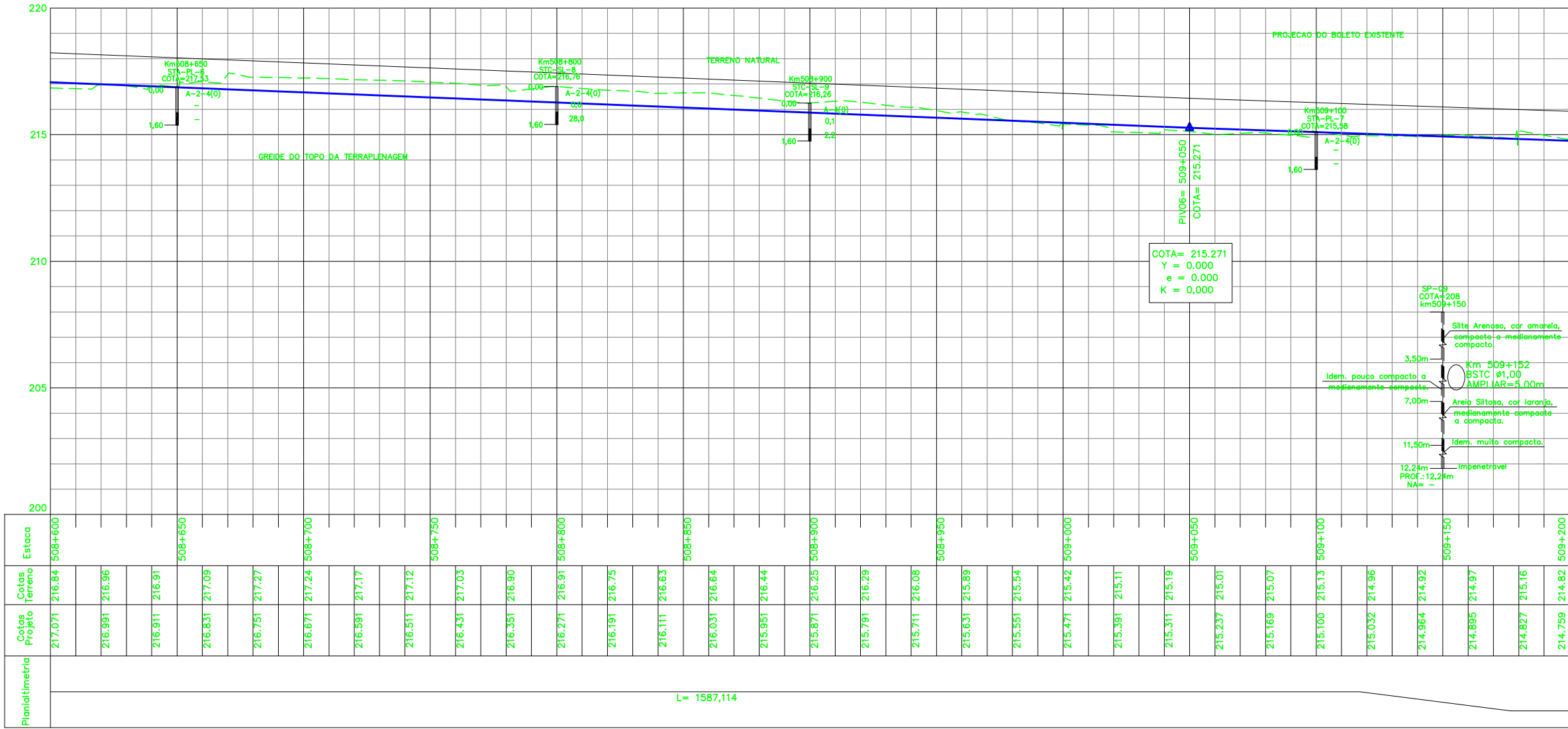

Estaca	Cotas Terreno	Cotas Projeto	Planialtimetria
508+600	216,84	217,071	L = 1587,114
508+650	216,96	216,991	
508+700	216,91	216,911	
508+750	217,09	216,831	
508+800	217,27	216,751	
508+850	217,12	216,671	
508+900	217,17	216,591	
508+950	217,12	216,511	
509+000	217,03	216,431	
509+050	216,90	216,351	
509+100	216,91	216,271	
509+150	216,75	216,191	
509+200	216,63	216,111	
509+250	216,64	216,031	
509+300	216,44	215,951	
509+350	216,25	215,871	
509+400	216,29	215,791	
509+450	216,08	215,711	
509+500	215,89	215,631	
509+550	215,54	215,551	
509+600	215,42	215,471	
509+650	215,11	215,391	
509+700	215,19	215,311	
509+750	215,01	215,231	
509+800	215,07	215,151	
509+850	215,13	215,071	
509+900	214,96	214,991	
509+950	214,92	214,911	
509+1000	214,97	214,831	
509+1050	214,16	214,751	
509+1100	214,82	214,671	
509+1150	214,16	214,591	
509+1200	214,82	214,511	
509+1250	214,16	214,431	
509+1300	214,82	214,351	
509+1350	214,16	214,271	
509+1400	214,82	214,191	
509+1450	214,16	214,111	
509+1500	214,82	214,031	
509+1550	214,16	213,951	
509+1600	214,82	213,871	
509+1650	214,16	213,791	
509+1700	214,82	213,711	
509+1750	214,16	213,631	
509+1800	214,82	213,551	
509+1850	214,16	213,471	
509+1900	214,82	213,391	
509+1950	214,16	213,311	
509+2000	214,82	213,231	
509+2050	214,16	213,151	
509+2100	214,82	213,071	
509+2150	214,16	212,991	
509+2200	214,82	212,911	
509+2250	214,16	212,831	
509+2300	214,82	212,751	
509+2350	214,16	212,671	
509+2400	214,82	212,591	
509+2450	214,16	212,511	
509+2500	214,82	212,431	
509+2550	214,16	212,351	
509+2600	214,82	212,271	
509+2650	214,16	212,191	
509+2700	214,82	212,111	
509+2750	214,16	212,031	
509+2800	214,82	211,951	
509+2850	214,16	211,871	
509+2900	214,82	211,791	
509+2950	214,16	211,711	
509+3000	214,82	211,631	
509+3050	214,16	211,551	
509+3100	214,82	211,471	
509+3150	214,16	211,391	
509+3200	214,82	211,311	
509+3250	214,16	211,231	
509+3300	214,82	211,151	
509+3350	214,16	211,071	
509+3400	214,82	210,991	
509+3450	214,16	210,911	
509+3500	214,82	210,831	
509+3550	214,16	210,751	
509+3600	214,82	210,671	
509+3650	214,16	210,591	
509+3700	214,82	210,511	
509+3750	214,16	210,431	
509+3800	214,82	210,351	
509+3850	214,16	210,271	
509+3900	214,82	210,191	
509+3950	214,16	210,111	
509+4000	214,82	210,031	
509+4050	214,16	209,951	
509+4100	214,82	209,871	
509+4150	214,16	209,791	
509+4200	214,82	209,711	
509+4250	214,16	209,631	
509+4300	214,82	209,551	
509+4350	214,16	209,471	
509+4400	214,82	209,391	
509+4450	214,16	209,311	
509+4500	214,82	209,231	
509+4550	214,16	209,151	
509+4600	214,82	209,071	
509+4650	214,16	208,991	
509+4700	214,82	208,911	
509+4750	214,16	208,831	
509+4800	214,82	208,751	
509+4850	214,16	208,671	
509+4900	214,82	208,591	
509+4950	214,16	208,511	
509+5000	214,82	208,431	
509+5050	214,16	208,351	
509+5100	214,82	208,271	
509+5150	214,16	208,191	
509+5200	214,82	208,111	
509+5250	214,16	208,031	
509+5300	214,82	207,951	
509+5350	214,16	207,871	
509+5400	214,82	207,791	
509+5450	214,16	207,711	
509+5500	214,82	207,631	
509+5550	214,16	207,551	
509+5600	214,82	207,471	
509+5650	214,16	207,391	
509+5700	214,82	207,311	
509+5750	214,16	207,231	
509+5800	214,82	207,151	
509+5850	214,16	207,071	
509+5900	214,82	206,991	
509+5950	214,16	206,911	
509+6000	214,82	206,831	

NOTAS	DOCUMENTOS DE REFERENCIA	REVISOES	ESCALA	Nº CONTRATADA	Nº VALE	REVISAO																																
1. AS MEDIDAS ESTAO EM METRO, EXCETO ONDE INDICADO 2. AS COORDENADAS ESTAO NO SISTEMA UTM SAD-69, MC-45 (CVRD).	GEO: 200K-B-13670; 200K-B-13682 TOP: 200K-V-13240 PARA PLANTA VER DESENHO N. 200K-B-13682	<table border="1"> <thead> <tr> <th>REV.</th> <th>T.E.</th> <th>DESCRICAO</th> <th>PROJ.</th> <th>DES.</th> <th>VER.</th> <th>APR.</th> <th>DATA</th> </tr> </thead> <tbody> <tr> <td>D</td> <td>C</td> <td>VALIDADO ATENDENDO A RAP RL-200K-G-23039</td> <td>GUIDA</td> <td>PRODEC</td> <td>MEENDES</td> <td>JUAREZ</td> <td>24/07/09</td> </tr> <tr> <td>B</td> <td>B</td> <td>FALTA ATENDER AOS COMENTARIOS DO RL-200K-G-23039</td> <td>GUIDA</td> <td>PRODEC</td> <td>MEENDES</td> <td>JUAREZ</td> <td>24/04/09</td> </tr> <tr> <td>A</td> <td>B</td> <td>PARA APROVACAO</td> <td>GUIDA</td> <td>PRODEC</td> <td>MEENDES</td> <td>JUAREZ</td> <td>03/03/09</td> </tr> </tbody> </table>	REV.	T.E.	DESCRICAO	PROJ.	DES.	VER.	APR.	DATA	D	C	VALIDADO ATENDENDO A RAP RL-200K-G-23039	GUIDA	PRODEC	MEENDES	JUAREZ	24/07/09	B	B	FALTA ATENDER AOS COMENTARIOS DO RL-200K-G-23039	GUIDA	PRODEC	MEENDES	JUAREZ	24/04/09	A	B	PARA APROVACAO	GUIDA	PRODEC	MEENDES	JUAREZ	03/03/09	1:1000	PRO627-10-PB-GEO-33	200K-B-14835	0
REV.	T.E.	DESCRICAO	PROJ.	DES.	VER.	APR.	DATA																															
D	C	VALIDADO ATENDENDO A RAP RL-200K-G-23039	GUIDA	PRODEC	MEENDES	JUAREZ	24/07/09																															
B	B	FALTA ATENDER AOS COMENTARIOS DO RL-200K-G-23039	GUIDA	PRODEC	MEENDES	JUAREZ	24/04/09																															
A	B	PARA APROVACAO	GUIDA	PRODEC	MEENDES	JUAREZ	03/03/09																															
		ESTRADA DE FERRO CARAJAS		N1030-02																																		
		GERAL PROGRAMA CAPACITACAO LOGISTICA NORTE - LOTE 05 SEGMENTO KM 502+863,457 AO KM 512+534,439 PROJETO GEOMETRICO - FERROVA - PERFIL - KM 508+600 AO KM 509+200																																				