

TABELA DE ARMADURAS (POR METRO DE GALERIA)

0 < h <= 100					100 < h <= 250					250 < h <= 500					500 < h <= 750					750 < h <= 1000					1000 < h <= 1250					1250 < h <= 1500									
f _s ≥ 0,20 MPa					f _s ≥ 0,15 MPa					f _s ≥ 0,15 MPa					f _s > 0,20 MPa					f _s ≥ 0,25 MPa					f _s ≥ 0,29 MPa					f _s ≥ 0,34 MPa									
N	Ø	Q	COMP	ESP.	N	Ø	Q	COMP	ESP.	N	Ø	Q	COMP	ESP.	N	Ø	Q	COMP	ESP.	N	Ø	Q	COMP	ESP.	N	Ø	Q	COMP	ESP.	N	Ø	Q	COMP	ESP.	N	Ø	Q	COMP	ESP.
1					1					1					1					1					1					1									
2	6,3	20	100	c/20	2	6,3	20	100	c/20	2	6,3	20	100	c/20	2	6,3	20	100	c/20	2	6,3	20	100	c/20	2	6,3	20	100	c/20	2	6,3	20	100	c/20					
3					3					3					3					3					3	6,3	20	110	c/20	3	6,3	20	110	c/20					
4	16,0	6	255	c/16	4	12,5	6	255	c/15	4	12,5	6	255	c/15	4	16,0	6	255	c/16	4	16,0	6	255	c/14	4	16,0	9	255	c/11	4	16,0	20	255	c/10					
5	16,0	14	260	c/14	5	12,5	14	260	c/13	5	12,5	14	260	c/13	5	16,0	14	260	c/14	5	16,0	14	260	c/14	5	16,0	18	260	c/11	5	16,0	20	260	c/10					
6					6	12,5	18	CORR		6	12,5	18	CORR		6					6	16,0	18	CORR		6	16,0	18	CORR		6	16,0	18	CORR						
7	16,0	12	CORR		7					7					7	16,0	12	CORR		7				7					7					7					
8	6,3	168	CORR	c/20	8	6,3	168	CORR	c/20	8	6,3	168	CORR	c/20	8	6,3	168	CORR	c/20	8	6,3	168	CORR	c/20	8	6,3	168	CORR	c/20	8	6,3	168	CORR	c/20	8	6,3	168	CORR	c/20
9	16,0	14	260	c/14	9	12,5	14	260	c/13	9	12,5	14	260	c/13	9	16,0	14	260	c/14	9	16,0	12	260	c/15	9	16,0	16	260	c/12	9	16,0	20	260	c/10	9	16,0	20	260	c/10
10	16,0	6	255	c/16	10	12,5	6	255	c/15	10	12,5	6	255	c/15	10	16,0	6	255	c/16	10	16,0	7	255	c/14	10	16,0	9	255	c/11	10	16,0	10	255	c/10	10	16,0	10	255	c/10
11	12,5	8	484	c/28	11	10,0	8	484	c/28	11	10,0	8	484	c/28	11	12,5	8	484	c/28	11	12,5	8	494	c/28	11	16,0	6	494	c/34	11	16,0	8	494	c/30	11	16,0	8	494	c/30
12	12,5	16	270	c/28	12	10,0	16	270	c/28	12	10,0	16	270	c/28	12	12,5	16	270	c/28	12	12,5	16	270	c/28	12	16,0	12	270	c/34	12	16,0	16	270	c/30	12	16,0	16	270	c/30
13	6,3	14	285	c/13	13	10,0	8	285	c/25	13	10,0	8	285	c/25	13	6,3	14	285	c/13	13	6,3	20	295	c/10	13	10,0	10	285	c/20	13	10,0	10	285	c/20	13	10,0	10	285	c/20
14					14					14					14					14					14					14					14				
15	6,3	10	180	c/20	15	6,3	10	180	c/20	15	6,3	10	180	c/20	15	6,3	10	180	c/20	15	6,3	10	180	c/20	15	6,3	10	180	c/20	15	6,3	10	180	c/20	15	6,3	10	180	c/20
16	6,3	12	285	c/15	16	10,0	8	285	c/30	16	10,0	8	285	c/30	16	6,3	12	285	c/15	16	6,3	12	295	c/15	16	10,0	8	285	c/25	16	10,0	8	285	c/25	16	10,0	8	285	c/25
RESUMO					RESUMO					RESUMO					RESUMO					RESUMO					RESUMO					RESUMO									
Ø	Kg/m	PESO(Kg)			Ø	Kg/m	PESO(Kg)			Ø	Kg/m	PESO(Kg)			Ø	Kg/m	PESO(Kg)			Ø	Kg/m	PESO(Kg)			Ø	Kg/m	PESO(Kg)			Ø	Kg/m	PESO(Kg)							
6,3	0,252	75			6,3	0,252	57			6,3	0,252	57			6,3	0,252	75			6,3	0,252	81			6,3	0,252	57			6,3	0,252	66							
12,5	0,988	81			10,0	0,624	80			10,0	0,624	80			12,5	0,988	81			12,5	0,988	82			10,0	0,624	34			10,0	0,624	34							
16,0	1,570	183			12,5	0,988	122			12,5	0,988	122			16,0	1,570	183			16,0	1,570	194			16,0	1,570	340			16,0	1,570	405							
TOTAL= 339 Kg					TOTAL= 259 Kg					TOTAL= 259 Kg					TOTAL= 339 Kg					TOTAL= 357 Kg					TOTAL= 431 Kg					TOTAL= 505 Kg									

SEÇÃO TRANSVERSAL

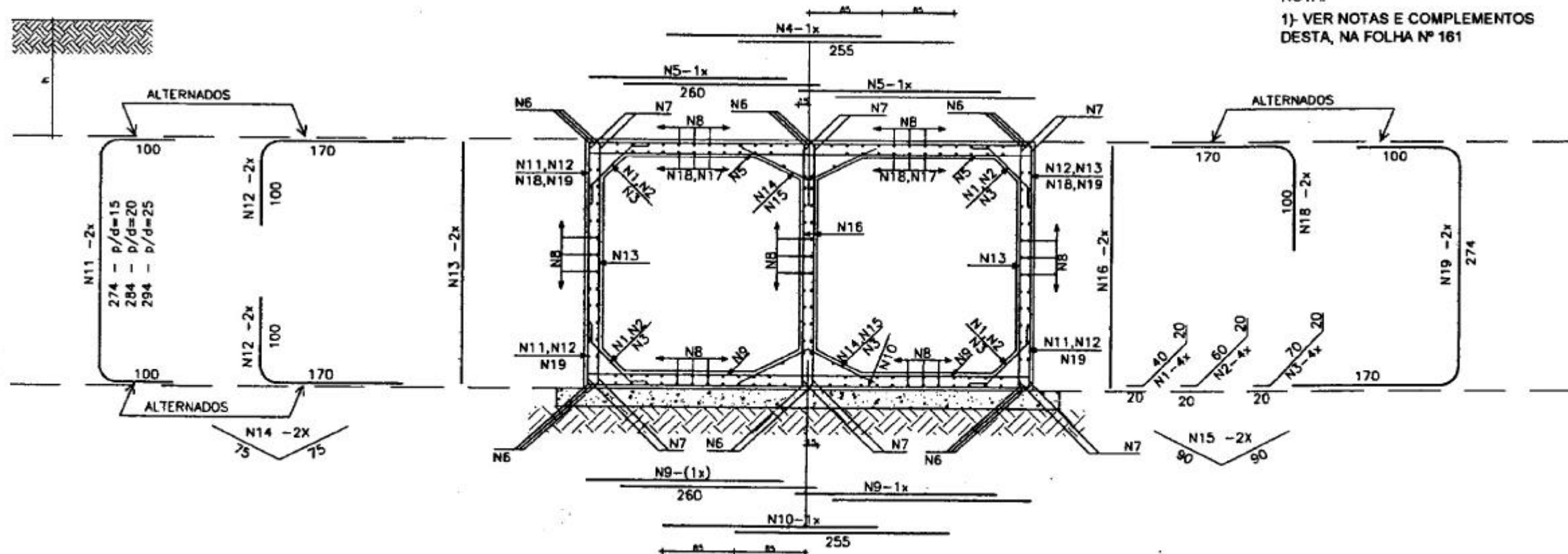

0	Emissão inicial - Minuta do Projeto Executivo		19/10/06	NK	CM
Revisão	Descrição		Data	Aprov.	Aut.
Aprovação	ECOPLAN	Autorização	ECOPLAN		
	CEHAB		CEHAB		
Elaboração:	Verificação:	Revisão	Referência Ecoplan:		
Luciano Santarém	Jorge M. Basler	0	-		



S.D.U.	COMPANHIA ESTADUAL DE HABITAÇÃO E OBRAS	CEHAB
ESCALAS:	Ferrovia: Transnordestina Trecho : Parnamirim - Araripina (112,6 km) Lote : 3	
DATA:	PROJETO DE DRENAGEM	FOLHA/TOTAL
OUT/06	Bueiros Duplos Celulares de Concreto Armaduras do Corpo - 2,50x2,50	D-80